

S I M P L E X



E V I A N

CATALOGUE No. 51 — JANUARY 1968

SUPPLEMENT TO CATALOGUE No. 50

As from 1st. Dec. 1968, ALL
RETAIL PRICES in Cat. 51 are
increased by 15%, except on
Pirelli and Detto Pietro where
new RETAIL Prices apply.

RETAIL LIST

THIS CATALOGUE No. 51 IS A SUPPLEMENT TO CATALOGUE No. 50
IN THE INDEX BELOW, WE GIVE GUIDANCE FOR USE

ADDITIONS AND AMENDMENTS

<u>Trade Marks</u>	<u>Pages</u>	<u>Remarks</u>
SIMPLEX	1 to 19	UP-TO-DATE LIST AND PRICES OF ALL SIMPLEX ITEMS, REPLACES ENTIRE SIMPLEX SECTION IN CATALOGUE No. 50
STRONGLIGHT	20	ON THESE PAGES, WE LIST THE 1968 RETAIL PRICES, BY CODE NUMBERS OF ITEMS. TO IDENTIFY ITEM, REFER TO DESCRIPTIONS IN CATALOGUE No. 50
PIVO	21	
AMBROSIO	21	
FB. HUBS	21	
E. SPOKES	21	
AURELIA	21	
MAFAC... ..	22	
DETTO PIETRO	25	
HELYETT	25	
PIRELLI... ..	25	
AVA-EVIAN	23	THESE ARE NEW ITEMS NOT LISTED IN CATALOGUE No. 50
NISI-EVIAN	24	

EVIAN (GB) LIMITED

69 MANOR PARK ROAD

HARLESDEN

LONDON, N.W.10

Telephone : 01-965 2510

SIMPLEX



REGISTERED TRADE MARKS

Nos. 579876, B683564, B718145, B728286, B760537, B763251, B896276

PATENTS AND REGISTERED DESIGNS

**SIMPLEX PRODUCTS ARE PROTECTED BY BRITISH AND FOREIGN PATENTS AND REGISTERED DESIGNS
PROPERTY LE DERAILLEUR SIMPLEX LTD.**



LE DERAILLEUR SIMPLEX LIMITED

69 MANOR PARK ROAD

HARLESDEN

LONDON, N.W.10

Telephone : 01-965 2510



Code No.	DESIGNATION AND SPECIFICATION	RETAIL PRICE
		per Unit
GEARS WITH HANDLEBAR CONTROL (O.E. Composition)		
1/HC	Simplex " Prestige 537/P " Gear, with Handlebar Control code 45 Each★	
1/HCR	Simplex " Prestige 537/P " Gear, with Handlebar Control code 46 Each★	
3/HC	Simplex " Prestige 537/NC " Gear, with Handlebar Control code 45 Each★	
3/HCR	Simplex " Prestige 537/NC " Gear, with Handlebar Control code 46 Each★	
7/HC	Simplex " Prestige 537/P-AV.223 " Gear and Front Changer, with Two Handlebar Controls code 45... .. Set ★	
7/HCR	Simplex " Prestige 537/P-AV.223 " Gear and Front Changer, with One Handlebar Control code 45 and one code 46 Set ★	
9/HC	Simplex " Prestige 537/NC-AV.223 " Gear and Front Changer, with Two Handlebar Controls code 45... .. Set ★	
9/HCR	Simplex " Prestige 537/NC-AV.223 " Gear and Front Changer, with One Handlebar Control code 45 and one code 46 Set ★	
12/HC	Simplex " Prestige-Criterium " Gear, with Handlebar Control code 45 (O.E., without Bracket Ref. 2546) ...Each★	
12/HCR	Simplex " Prestige-Criterium " Gear, with Handlebar Control code 46 (O.E., without Bracket Ref. 2546) ...Each★	
14/HC	Simplex Prestige " Criterium-AV.223," Gear and Front Changer, with Two Handlebar Controls code 45 (O.E., without Bracket Ref. 2546) Set ★	
14/HCR	Simplex Prestige " Criterium-AV.223," Gear and Front Changer, with One Handlebar Control code 45 and One code 46 (O.E., without Bracket Ref. 2546) Set ★	
52/4	Simplex Ref. 1224.B, Clip-On (Single) cable stop (For Tube 1½ inch) Each★	
52/5	Simplex Ref. 1225.B, Clip-On (Double) cable stop (For Tube 1½ inch) Each★	
SIMPLEX FREEWHEELS (O.E.)		
66/OE	Simplex Freewheels, 5-Speed, 14-16-18-21-24.T (O.E. Version, Sachet) Each★	
72/OE	Simplex Freewheel, 6-Speed, 13-15-17-19-21-24.T (O.E. Version, Sachet) Each★	
SIMPLEX FORK ENDS, FRONT AND REAR—SIMPLEX Braze-on parts		
18/1	Pair, Simplex Ref. 881/881B, Rear Fork Ends Pair ...	8/3
18/2	Pair, Simplex Ref. 1600/1601, Rear Fork Ends with Gear Support Pair ...	6/3
18/3	Pair, Simplex Ref. 1752/1753, Rear Fork Ends with Gear Support Pair ...	15/6
18/4	Pair, Simplex Ref. 1611/1611.G, Rear Fork Ends with Gear Support Pair ...	13/6
18/5	Pair, Simplex Ref. 932/933, Front Fork Ends Pair ...	4/3
19/1	Simplex Ref. 599, Lever Boss	9d.
19/2	Simplex Ref. 894, Cable Tunnel, Single, R/H	9d.
19/3	Simplex Ref. 1440.B, Cable Eye	9d.
19/7	Simplex Ref. 1094, Cable Tunnel, Single, L/H... ..	9d.



Code No.	DESIGNATION AND SPECIFICATION	RETAIL PRICE per Unit
FRONT CHANGERS—BOXED—(CLIP-ON)—(Changer Mechanism, Control Lever with Cable and Outer Casing)		
24	Simplex "Competition" Front Changer	19/9
25	Simplex "Prestige AV.223" Front Changer with L/H Lever Ref. 2531.A, Boxed	39/-
25/1	Simplex "Prestige AV.223" Front Changer with Double Lever 2532.A, Boxed	45/-
26	Simplex "Prestige AV.223" Front Changer with L/H Lever 2541.A (On Perf. Clip), Boxed	39/-
28	Simplex "Prestige AV.223" Front Mechanism complete (Less Lever), Sachet	29/3
REAR DERAILLEUR GEARS, Boxed (Gear Mechanism, Control Lever with Cable and Outer Casing) —Model "P" fits Standard Fork Ends —Model "NC" fits Fork Ends made for Italian Gears, and Simplex Rear Fork End Type 1600/1601, 1752/1753 —Model "Criterion" fits Standard Fork Ends as well as Fork Ends with Gear Hanger		
30/P	Simplex "Prestige 537/P" Gear with R/H Lever 2530.A, Boxed	45/-
32/NC	Simplex "Prestige 537/NC" Gear with R/H Lever 2530.A, Boxed	45/-
33	Simplex "Prestige Criterion" Gear with R/H Lever 2530.A/Luxe, (Metal Covered), Boxed	87/-
GEAR AND FRONT CHANGER COMBINATION—BOXED Composition :—One "Prestige" Gear Mechanism Model P, NC, or "Criterion" One "Prestige AV.223" Front Mechanism —One Double Lever Unit, R/H and L/H, clip-on, with Cables and Outer Casing		
34	Simplex Criterion-AV.223, Gear and Front Changer with Double Lever Ref. 2532. A/Luxe, (Metal Covered), Boxed	126/3
35	Simplex 537/P-AV.223, Gear and Front Changer with Double Lever 2532.A, Boxed	81/3
37	Simplex 537/NC-AV.223, Gear and Front Changer with Double Lever 2532.A, Boxed	81/3
REAR DERAILLEUR MECHANISM ONLY		
38	Simplex "Prestige 537/P," Mechanism only	35/3
40	Simplex "Prestige 537/NC," Mechanism only	35/3
41	Simplex "Prestige-Criterion," Mechanism only	74/3
PRESELECTOR LEVER UNIT (with Cable and Outer Casing)		
44	Simplex Preselector Lever Unit, "Click Shift," with cable and Outer Casing	45/-
HANDLEBAR CONTROL LEVER (with Cable and Outer Casing) (Relais 2343 is available as a unit, Code 53)		
45	Simplex Handlebar Control Ref. 2615.A, with Cable 2632 (79 inch) and White Outer Casing... ..	34/9
46	Simplex Handlebar Control Ref. 2615.A, with Relais 2343, with Cable 2632 (79 inch), and two White Outer Casings... ..	51/-
49	Simplex Security Stop Ref. 2585each	1/9



Code No.	DESIGNATION AND SPECIFICATION	RETAIL PRICE
		per Unit
50	LEVER UNITS, CLIP-ON, FOR "PRESTIGE" GEARS (Fit Tube 1 1/8")	
50/1	Simplex 2530.A, R/H Lever Unit with cable and casing	9/9
50/2	Simplex 2531.A, L/H Lever Unit on D/Clip, with cable and casing	9/9
50/3	Simplex 2532.A, Double Lever Unit with cables and casing... ..	16/9
50/4	Simplex 2541.A, L/H Lever Unit on perforated clip, with cable and casing	9/9
50/7	Simplex 2530.A/Luxe, (Metal Covered), R/H Lever Unit with Cable and Outer Casing	12/9
50/8	Simplex 2532. A/Luxe, (Metal Covered), Double Lever Unit with Cables and Outer Casing	22/9
51	LEVER UNITS, BRAZE-ON, FOR "PRESTIGE" GEARS	
51/1	Simplex 2540.B, R/H Lever Unit, Braze-on, with cable	5/9
51/2	Simplex 2540.B (G), L/H Lever Unit, Braze-on, with cable	5/9
52	FRAME FITTINGS—CLIP-ON (including Clip, Screw, Nut)	
52/1	Sets, Simplex Ref. 2111, casing clip 1 1/8" (set of 3)	7/9
52/2	Simplex Ref. 2112, Casing stop 7/16"	3/-
52/3	Simplex Ref. 2113, Tunnel/Casing stop 1 1/8"	8/9
52/4	Simplex Ref. 1224.B, Clip-on (Single) cable stop (for Tube 1 1/8")each	5/9
52/5	Simplex Ref. 1225.B, Clip-on (Double) cable stop (for Tube 1 1/8")each	7/-
53	DEMULTIPLICATOR RELAIS	
53	Simplex Demultiplier Relais 2343, Lever to gear, (clip-on, complete with cable)each	16/9
54	GEAR ROLLERS	
54/1	Sachet Ref. S/10—(2 Rollers 1882 for "Prestige 537" gears, Models 1965 to 1967)Sachet	7/-
54/2	Sachet Ref. S/12—(2 Rollers 2052 on Ball Bearing, for "Criterium" gears)Sachet	15/9
54/3	Sachet Ref. S/14—(2 Rollers 2648 for "Prestige 537" gears, Model 1968)Sachet	7/-
54/4	Sachet Ref. S/16—(2 Rollers 2651 on Ball Bearing, for "Criterium" Gear Model 1968)Sachet	15/9
55	CABLES AND OUTER CASING	
55/1	Simplex Ref. 2334, Rear cable "Prestige-Criterium"each	2/-
55/2	Simplex Ref. 2338, Front Cable (AV.223)each	1/9
55/3	Simplex Ref. 2344, Cable for Relais 2343each	2/-
55/4	Simplex Ref. 2632, Special Cable for Handlebar Control, gear side (79")each	9/-
55/5	Simplex Ref. 2633, Special Cable for Handlebar Control (Front Changer Side—57")each	7/-
55/6	Simplex Ref. 594, Rear Cable Casing, Whiteeach	2/9
55/7	Simplex Ref. 1786, Front Cable Casing, Whiteeach	2/-



Code No.	DESIGNATION AND SPECIFICATION		RETAIL PRICE per Unit
SIMPLEX FREEWHEELS			
<p>Simplex Freewheels are available in all teeth Combinations from 14 to 24 Teeth, 26 and 28 Teeth in 3- and 4-speed $\frac{1}{8}$" 4- and 5-speed $\frac{3}{32}$". All the sprockets are detachable from the Freewheel Body. Freewheels 5-speed and 6-speed $\frac{3}{32}$" are available from 13 Teeth to 28 Teeth. We list below the teeth Combinations we recommend. These sizes are ready stock, assembled and Boxed. Other teeth Combinations will be delivered unassembled.</p>			
FREEWHEELS—ASSEMBLED AND BOXED			
57	Simplex Freewheels, Boxed, $3 \times \frac{1}{8}$ " 14-16-18T		19/9
58	Simplex Freewheels, Boxed, $3 \times \frac{1}{8}$ " 15-17-19T		19/9
60	Simplex Freewheels, Boxed, $4 \times \frac{1}{8}$ " 14-16-18-21T		24/9
61	Simplex Freewheels, Boxed, $4 \times \frac{1}{8}$ " 15-17-19-22T		24/9
63	Simplex Freewheels, Boxed, $4 \times \frac{3}{32}$ " 14-16-18-21T		24/9
64	Simplex Freewheels, Boxed, $4 \times \frac{3}{32}$ " 15-17-19-22T		24/9
66	Simplex Freewheels, Boxed, $5 \times \frac{3}{32}$ " 14-16-18-20-23T		28/9
67	Simplex Freewheels, Boxed, $5 \times \frac{3}{32}$ " 15-17-19-21-24T		28/9
FREEWHEELS—NON-ASSEMBLED			
68	Simplex Freewheels, NON/ASSD, $3 \times \frac{1}{8}$ ", (Specify Sprocket Combination) ... (From 14T)		Price of Freewheel is made up by adding the prices of bodies and sprockets
69	Simplex Freewheels, NON/ASSD, $4 \times \frac{1}{8}$ ", (Specify Sprocket Combination) ... (From 14T)		
70	Simplex Freewheels, NON/ASSD, $4 \times \frac{3}{32}$ " (Specify Sprocket Combination) ... (From 14T)		
71	Simplex Freewheels, NON/ASSD, $5 \times \frac{3}{32}$ " (Specify Sprocket Combination) ... (From 13T)		
71/1	Simplex Freewheels, NON/ASSD, $6 \times \frac{3}{32}$ " (Specify Sprocket Combination) ... (From 13T)		
72	SIMPLEX FREEWHEELS—PARTS		
BODIES			
75	Freewheel, Body, $3 \times \frac{1}{8}$ "		8/9
76	Freewheel, Body, $4 \times \frac{1}{8}$ " and $4 \times \frac{3}{32}$ "		9/3
77	Freewheel, Body, $5 \times \frac{3}{32}$ "		10/-
SPROCKETS—(Packed each in Plastic Sachet and Referenced)			
78	Freewheel Sprockets, from 14 to 24 Teeth ($\frac{1}{8}$ or $\frac{3}{32}$)		4/8
78/A	Freewheel Sprockets, 25 and 26 Teeth ($\frac{1}{8}$ or $\frac{3}{32}$)		6/-
78/B	Freewheel Sprockets, 28 and 30 Teeth ($\frac{1}{8}$ or $\frac{3}{32}$)		6/8
78/1	Sprocket Combination, 13/14 Teeth, (Screwed in)		9/8
78/2	Sprocket Combination, 13/15 Teeth, (Screwed in)		9/8
PARTS			
79	Freewheel Bearing Plate "SIMPLEX"		2/9
80	Sachet PS/1, ... (Contains 48 Pawl Springs)		3/6
81	Sachet P/2, ... (Contains 24 Pawls)		7/9
82	Sachet SW/3, ... (Contains 24 Shim Washers)		3/9

Code No.	DESIGNATION AND SPECIFICATION	RETAIL PRICE
		per Unit
83	Simplex Spoke Protection Disc, Steel, Chrome Plated, Large Diameter, 7½"	8/-
84	Spoke Protection Disc, Dural	1/-
85	SIMPLEX TOOLS	
85/1	Freewheel Remover " Standard "	22/9
85/2	Device for Holding Freewheel Body	49/-
85/3	Hand Tap for Simplex Lever Boss Ref. 599	5/9
85/4	Hand Tap for Simplex Rear Fork End	7/9
	SIMPLEX SEAT PILLAR	
86	Simplex Seat Pillar " Special Course," Steel, Chrome Plated (Available in diameter m/m, 26 — 26, 2 — 26, 4 — 26, 8 — 27 — 27, 2)	55/-

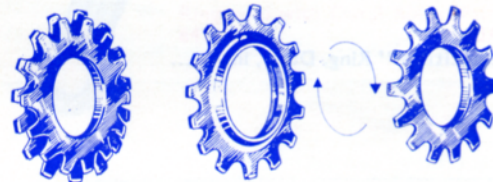
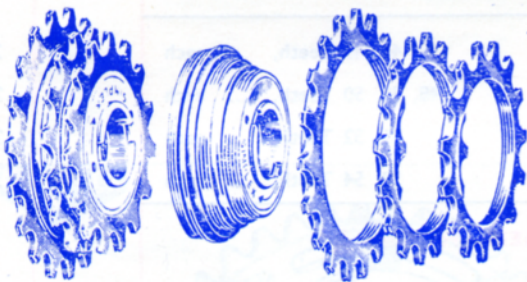

The 13 Tooth sprocket is delivered screwed in to a 14.T or a 15 Tooth sprocket and this Combination fits a 4-speed body to obtain a 5-speed Freewheel, and to a 5-speed Body to obtain a 6-speed Freewheel. This Combination is available in (Code 78/1) 13/14 Teeth, and (Code 78/2) in 13/15 Teeth.

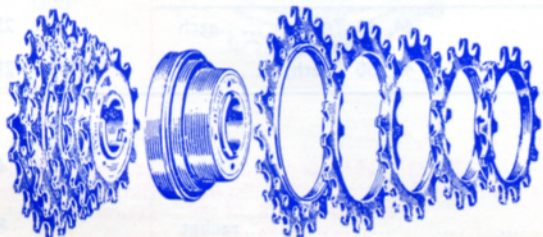
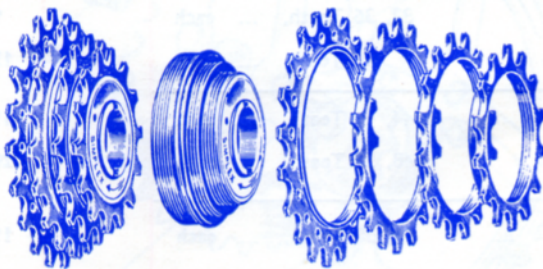

Freewheel Composition : 3 Sprocket Diameters
S=Small, M=Medium, L=Large

3 × 1/8" ...	S	M	L	4 × 3/32" ...	S	M	L
	1	1	1		1	1	2
4 × 1/8" ...	S	M	L	5 × 3/32" ...	S	M	L
	1	1	2		2	1	2

- 3 × 1/8" (S) — Teeth, 14, 15, etc., up to 21T
- 3 × 1/8" (M) — Teeth, 16, 17, etc., up to 23T

- 4 × 1/8" (S) — Teeth, 14, 15, etc., up to 21T
- 4 × 1/8" (M) — Teeth, 16, 17, etc., up to 23T

- 3 and 4 × 1/8" (L) — Teeth, 17, 18, etc., up to 24T, 26, 28

- 4 and 5 × 3/32" (S) — Teeth, 14, 15, etc., up to 21T
- 4 and 5 × 3/32" (M) — Teeth, 16, 17, etc., up to 23T
- 4 and 5 × 3/32" (L) — Teeth, 17, 18, etc., up to 26T, 28T



SIMPLEX DOUBLE CHAINWHEELS — FOR CHAIN $\frac{3}{32}$ "
(DELIVERED UNASSEMBLED — ORDER RINGS AND SCREWS)

<p>" GRAND SPORT "—5 PIN ORDER :</p> <p>1 INNER RING, $\frac{\text{Steel}}{\text{(Code 101)}}$ or $\frac{\text{Dural}}{\text{(Code 103)}}$</p> <p>1 OUTER RING, $\frac{\text{Steel}}{\text{(Code 102)}}$ or $\frac{\text{Dural}}{\text{(Code 104)}}$</p> <p>1 SACHET AC.3 (Code 108) (All Assembling Screws)</p>	<p>" COMPETITION "—3 ARM (STRAIGHT) ORDER :</p> <p>(For Use with Cranks made for Double Rings)</p> <p>2 RINGS, $\frac{\text{Steel}}{\text{(Code 99)}}$ or $\frac{\text{Dural}}{\text{(Code 100)}}$</p> <p>1 SACHET AC.1 (Code 106) (All Assembling Screws and Arms)</p>	<p>" COMPETITION "—3 ARM (CRANKED) ORDER :</p> <p>(For Use with Cranks made for Single Ring)</p> <p>2 RINGS, $\frac{\text{Steel}}{\text{(Code 99)}}$ or $\frac{\text{Dural}}{\text{(Code 100)}}$</p> <p>1 SACHET AC.2 (Code 107) (All Assembling Screws and Arms)</p>
-----------------------------------------------------------------------------------------------------------------------------------------------------------------------------------------------------------------------------------------------------------------------------------------------------------------------------------------------------------------------------	--------------------------------------------------------------------------------------------------------------------------------------------------------------------------------------------------------------------------------------------------------------------------------------------------------------	------------------------------------------------------------------------------------------------------------------------------------------------------------------------------------------------------------------------------------------------------------------------------------------------------------

Code No.	DESIGNATION AND SPECIFICATION	RETAIL PRICES per Unit
RINGS FOR " COMPETITION "—3 ARM—DOUBLE CHAINWHEEL—For Chain $\frac{3}{32}$"		
STEEL		
99	" Competition " Ring, Steel, in 45, 46, 47 Teeth, ... each	11/3
	48, 49, 50 Teeth, ... each	11/9
	51, 52 Teeth, ... each	12/9
DURAL		
100	" Competition " Ring, Dural, in 45, 46, 47 Teeth, ... each	21/3
	48, 49, 50 Teeth, ... each	23/9
	51, 52 Teeth, ... each	25/9
	53, 54 Teeth, ... each	33/-
RINGS FOR " GRAND SPORT "—5 PIN—DOUBLE CHAINWHEEL—For Chain $\frac{3}{32}$"		
STEEL		
101	" Grand Sport " Ring, Steel, Inner, in 28, 30 Teeth, ... each	8/3
	32, 36 Teeth, ... each	9/-
	40 Teeth, ... each	15/9
102	" Grand Sport " Ring, Steel, Outer, (without screws), in... .. 44, 46 Teeth, ... each	19/-
	48, 50 Teeth, ... each	20/9
DURAL		
103	" Grand Sport " Ring, Dural, Inner, in 28, 30 Teeth, ... each	11/-
	32, 36 Teeth, ... each	13/9
	40 Teeth, ... each	17/-
104	" Grand Sport " Ring, Dural, Outer, (without screws), in 44, 46 Teeth, ... each	25/9
	48, 50 Teeth, ... each	28/-
ASSEMBLING PARTS FOR SIMPLEX DOUBLE CHAINWHEEL		
106	Sachet Ref. AC.1 ... (Ref. $\frac{990}{3}$, $\frac{991.B}{6}$, $\frac{977}{6}$) sachet	6/9
107	Sachet Ref. AC.2 ... (Ref. $\frac{998}{3}$, $\frac{991.B}{6}$, $\frac{977}{6}$) sachet	8/-
108	Sachet Ref. AC.3 ... (Ref. $\frac{993}{5}$, $\frac{994}{5}$, $\frac{697}{3}$, $\frac{698}{3}$, $\frac{699}{3}$) sachet	6/3



(Code No. 24) "COMpetition" Front Changer, simple and efficient direct operation.

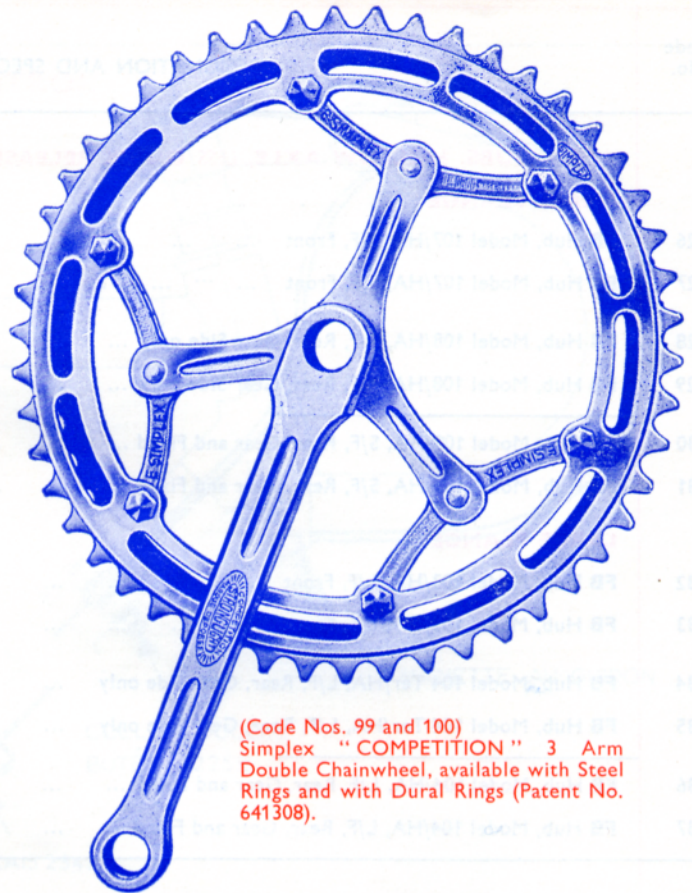

(Code Nos. 99 and 100)
Simplex "COMpetition" 3 Arm Double Chainwheel, available with Steel Rings and with Dural Rings (Patent No. 641308).

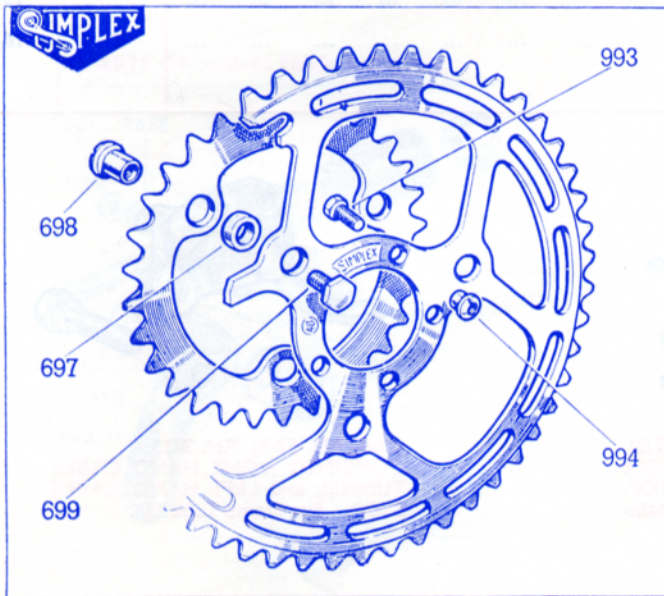

(Code Nos. 101, 102 in Steel, and 103, 104 in Dural)
Simplex "GRAND SPORT" 5 Pin Double Chainwheel available with :
Inner Rings : 28, 30, 32, 36, 40 Teeth
Outer Rings : 44, 46, 48, 50 Teeth
For Complete Set of Screws, order Sachet AC.3 (Code 108)

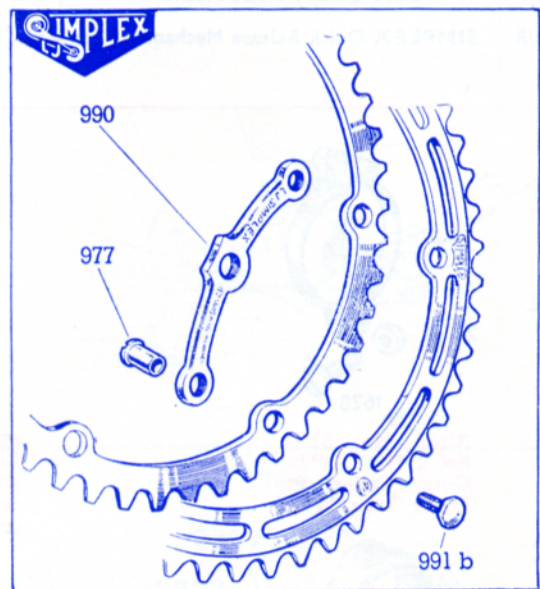

INNER AND OUTER RINGS Fully Interchangeable.
ARM Ref. 990 Fits Cranks made for Double Rings.
ARM Ref. 998 Replaces Ref. 990 when Cranks used are made for a Single Ring.
For Complete Set of Arms and Screws, order :
Sachet AC.1, with straight ARM Ref. 990, (Code 106), or
Sachet AC.2, with cranked ARM Ref. 998, (Code 107).

Code No.	DESIGNATION AND SPECIFICATION	RETAIL PRICE
		per Unit
"FB" HUBS, HOLLOW AXLE, LESS QUICK RELEASE MECHANISM		
SMALL FLANGE		
126	FB Hub, Model 107/HA, S/F, Front 32 Holes	39/-
127	FB Hub, Model 107/HA, S/F, Front 36 Holes	39/-
128	FB Hub, Model 108/HA, S/F, Rear, Gear Side only 36 Holes	47/3
129	FB Hub, Model 108/HA, S/F, Rear, Gear Side only 40 Holes	47/3
130	FB Hub, Model 109/HA, S/F, Rear, Gear and Fixed 36 Holes	49/6
131	FB Hub, Model 109/HA, S/F, Rear, Gear and Fixed 40 Holes	49/6
LARGE FLANGE		
132	FB Hub, Model 103/HA, L/F, Front 32 Holes	47/9
133	FB Hub, Model 103/HA, L/F, Front 36 Holes	47/9
134	FB Hub, Model 104 Ter/HA, L/F, Rear, Gear Side only 36 Holes	57/3
135	FB Hub, Model 104 Ter/HA, L/F, Rear, Gear Side only 40 Holes	57/3
136	FB Hub, Model 104/HA, L/F, Rear, Gear and Fixed 36 Holes	59/6
137	FB Hub, Model 104/HA, L/F, Rear, Gear and Fixed 40 Holes	59/6
SIMPLEX QUICK RELEASE MECHANISM (For use with Hollow Axle Hubs)		
138/F	SIMPLEX Quick Release Mechanism, Complete, Front	15/-
138/R	SIMPLEX Quick Release Mechanism, Complete, Rear	16/3



(Code No. 52/1),
Ref. 2111. CLIP for
Outer Casing, fits
Frame Tube 1 1/8" D.



(Code No. 52/2),
Ref. 2112. CABLE
(O/Casing) STOP,
fits on Rear Chain-
stay.



(Code No. 52/3), Ref. 2113.
COMBINED RIGHT HAND CABLE
TUNNEL and LEFT HAND CABLE
STOP. Fits Frame Tube 1 1/8".

(Code No. 52/4),
Ref. 1224.B. SINGLE
CABLE STOP.



**ALL THESE PARTS IN STEEL
CHROME PLATED**

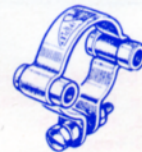

(Code No. 52/5),
Ref. 1225.B.
DOUBLE CABLE
STOP.

HANDLEBAR CONTROL

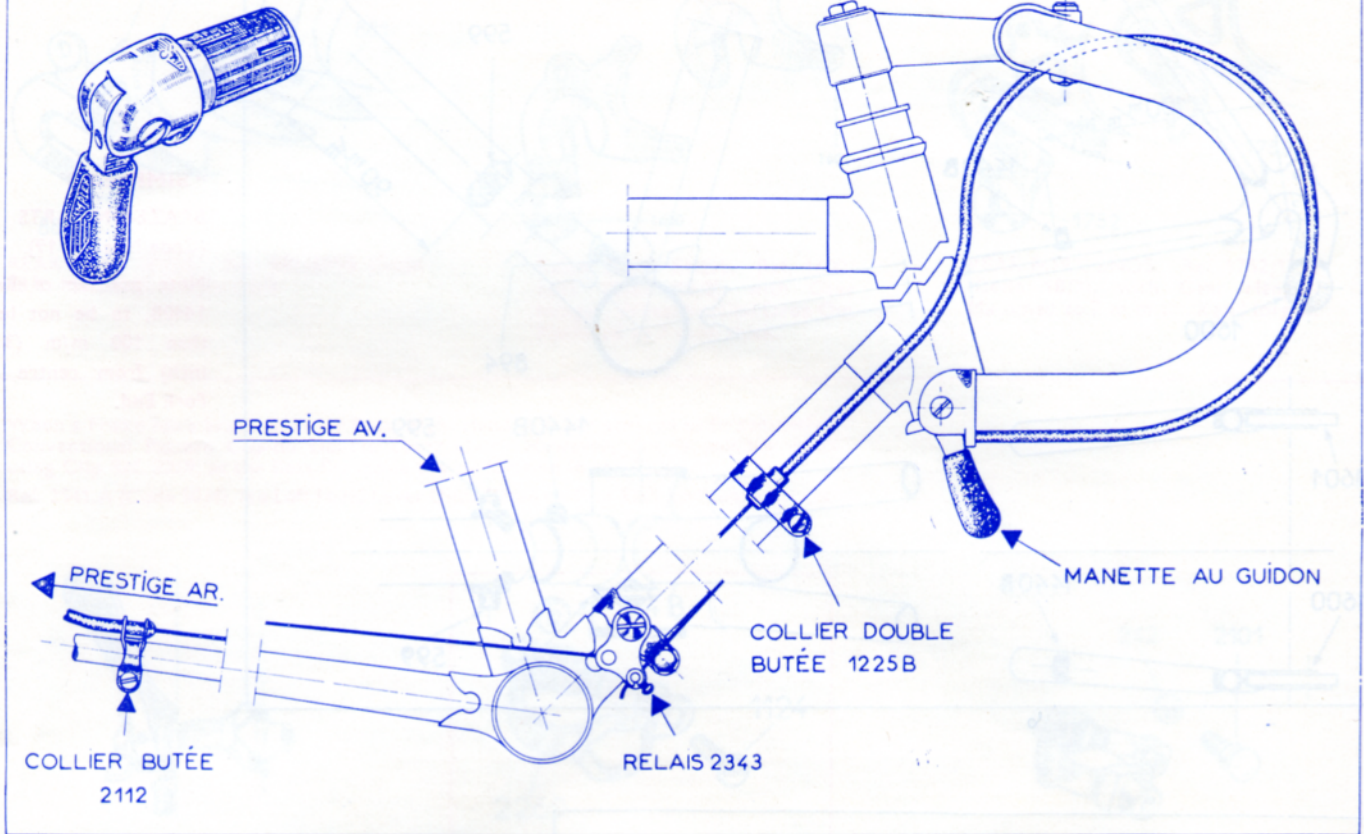

PARTS OF HANDLEBAR CONTROL

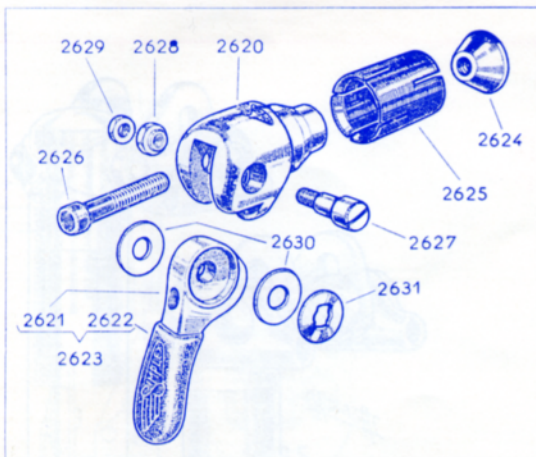

DEMULTIPLICATOR RELAIS

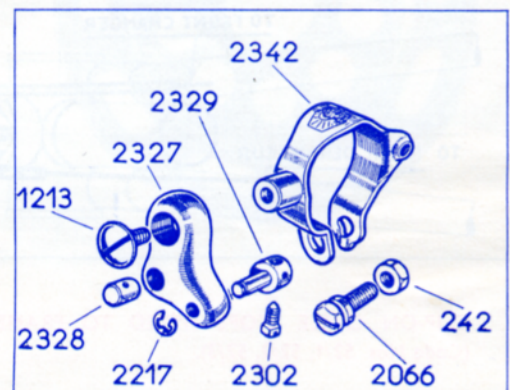
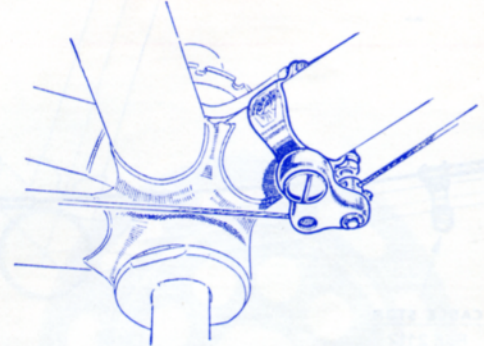

(Code No. 53). Ref. 2343 — This is a Demultiplier Relais. One side is connected to the Right Hand Control Lever, the other side to the Rear Derailleur. The purpose is to "spread" the movement of the lever making gear changing a positive "no fumbling" operation, especially on Close Ratio Freewheels.

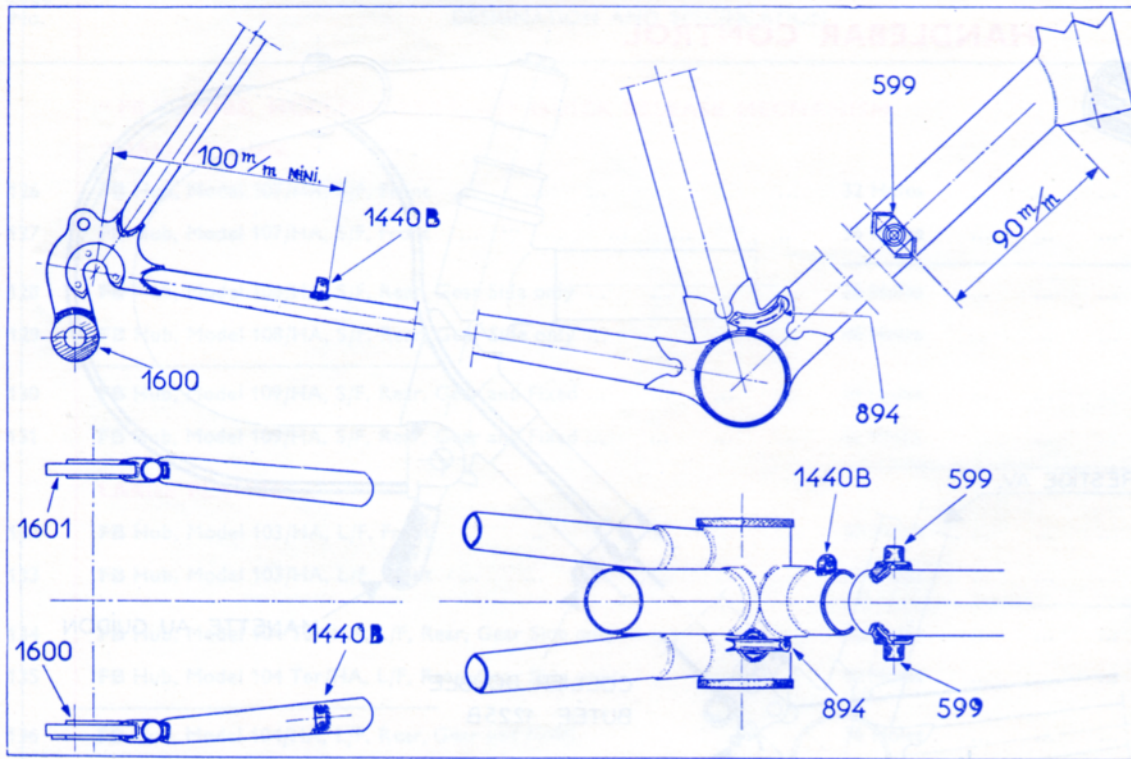

"SIMPLEX"
BRAZE-ON PARTS
 (Code Nos. 18, 19).
 Note position of Ref. 1440B, to be not less than 100 m/m ($3\frac{1}{8}$ inch) from centre of Fork End.

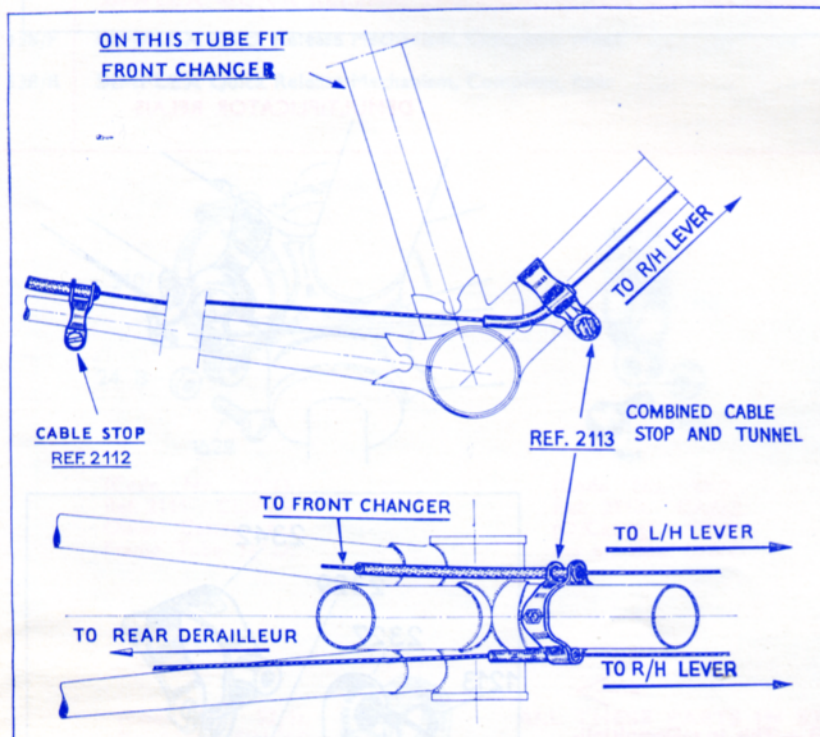

CLIP-ON CABLE STOPS FITTED TO FRAME.
 (Code Nos. 52/1, 52/2, 52/3).

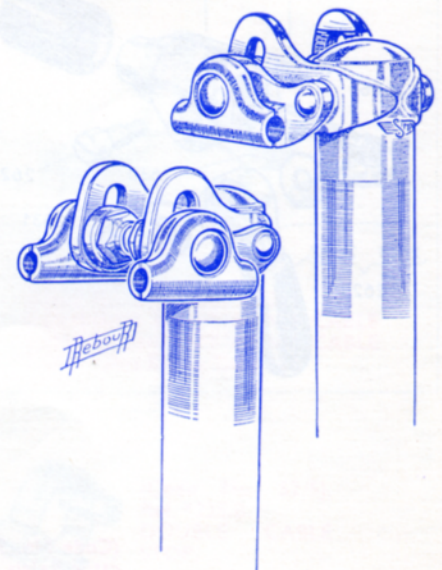

(Code No. 86) — Simplex Seat Pillar for Racing Cycles. Fully Adjustable.

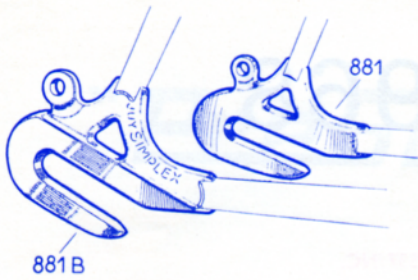

REAR FORK ENDS. Ref. 881/881B (Code 18/1, Machined, 5 m/m thick.

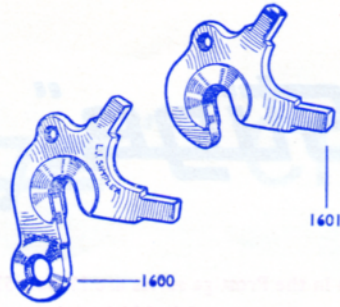

REAR FORK ENDS. Ref. 1600/1601 (Code 18/2), with Gear Hanger, Wheel Vertical Drop Out Machined to 7 m/m thick.

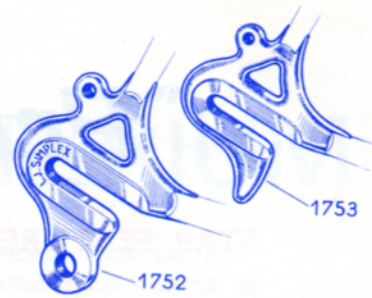

REAR FORK ENDS. Ref. 1752/1753 (Code 18/3), with Gear Hanger, Machined to 7 m/m thick and forged.

When a Frame has a braze-on Lever Boss, Right Hand, it is not possible to fit correctly a Conventional Pattern Clip-on Double Lever Unit. However, this is possible when using Clip Ref. 2269, as the Boss fits inside the perforation in the Clip.

Ref. 2541.A (Code 50/4), is a Left Hand Lever Unit, Fitted on Clip 2269, and ready for use.

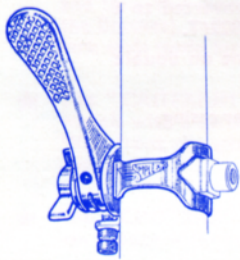

LEVER UNIT. Ref. 2541.A (Code 50/4), on perforated clip.

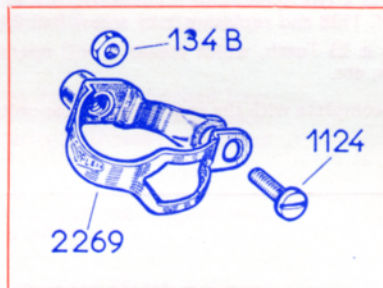

PERFORATED LEVER CLIP. Ref. 2269 (with 1124 and 134B).

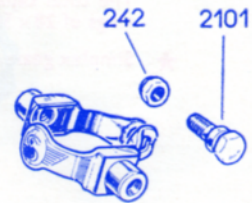

Ref. 2025. DOUBLE LEVER CLIP, Steel, for Tube $1\frac{1}{8}$ " De Luxe C/Plated.

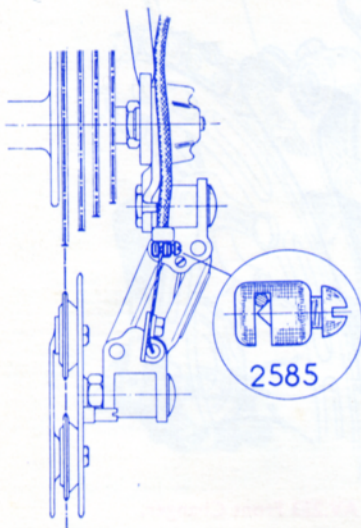

(Code No. 83) SIMPLEX SPOKE PROTECTION DISC. Diameter $7\frac{1}{2}$ ".

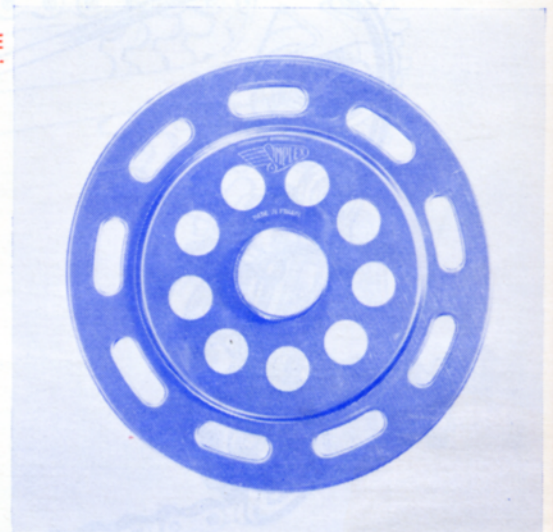

(Code 49), Part 2585, SECURITY STOP. When the gear is correctly adjusted, Part 2585 is clamped on to the cable and will thus prevent the mechanism from being driven into the wheel spokes.

"Prestige" 1968

STAR FEATURES

- ★ SIMPLEX Rear Derailleur Gears in the Prestige series are Models 537/P and 537/NC. They are made from Delrin, a space-age material of high resistance. Simplex gears are more resistant than gears of the same weight made in steel.
- ★ SIMPLEX Gears have unique patented features that make them superior to other gears in ease and reliability of operation.
Models 537/P and 537/NC will operate on 3-speed to 6-speed freewheels with a sprocket combination from 13 teeth to 28 teeth. With a front changer the overall capacity is 37 teeth total front and rear.
- ★ Model 537/P is designed to fit on to standard fork ends only, by means of a bracket fitted to the gear. This model cannot be converted to fit other types of fork ends.
- ★ Model 537/NC is supplied without bracket and will fit Simplex fork ends with gear hanger and also fork ends made for Italian gears.
Model 537/NC can be converted to fit standard fork ends by fitting Simplex gear bracket Ref. 1645.
- ★ Front changer AV.223 is supplied as a two-speed unit. However, this changer can be converted to a 3-speed by changing one screw Ref. 1928 and replacing it by screw Ref. 24, and 1922 by 1922/T. The total capacity of this changer is 23 Teeth, which means it will operate at its extreme on double rings of 28×50.T, or 30×52 Teeth, etc.
- ★ Simplex gears are supplied boxed, complete with the appropriate lever unit, cables and outer casing.

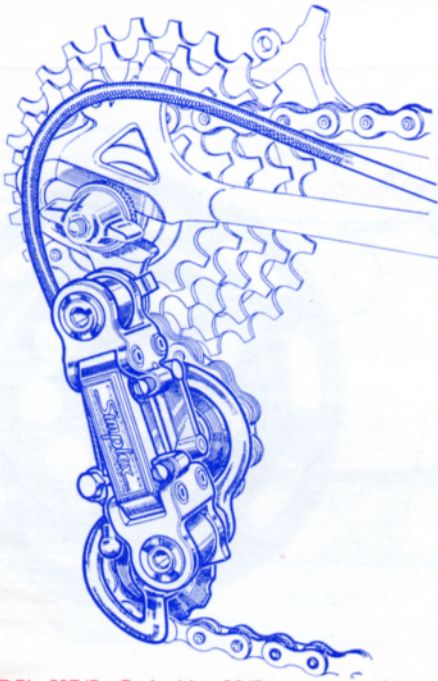

MODEL 537/P, Code No. 30/P, gear complete.
MODEL 537/NC, Code No. 32/NC, gear complete.
CODE No. 38 and 40, gear mechanism only.



"Prestige" Model AV.223 Front Changer.

Code No. 25 and 25/1, complete with level and cable.
Code No. 28, mechanism only.

"PreStige" CRITERIUM

MODEL "CRITERIUM"

STAR FEATURES

- ★ Also made of Delrin the Simplex "CRITERIUM" Gear has been designed as a De Luxe version of the Prestige 537, and as a Racing Gear.
Both Rollers are made from Delrin and mounted on ball bearings. This gear is extremely silent in operation.
- ★ The "CRITERIUM" gear has many international victories to its credit, such as the Tour De France, Champion Du Monde, etc.
- ★ The "CRITERIUM" is supplied with a gear bracket Ref. 2546 and thus, this model can be fitted to standard fork ends (with the Bracket), and to Simplex fork ends with gear hanger and to fork ends made for Italian gears.
- ★ The "CRITERIUM" will operate on 3-speed to 6-speed free-wheels with a sprocket combination from 13 teeth to 28 teeth. With front changer the overall capacity is 37 teeth total front and rear.
- ★ The "CRITERIUM" is truly a superior gear and Cyclists who use it once will not willingly use any other gear.
- ★ NOTE : "CRITERIUM" Gears (Code 33 and 34) are delivered with covered metal levers Ref. 2530.A/Luxe and 2532.A/Luxe respectively.

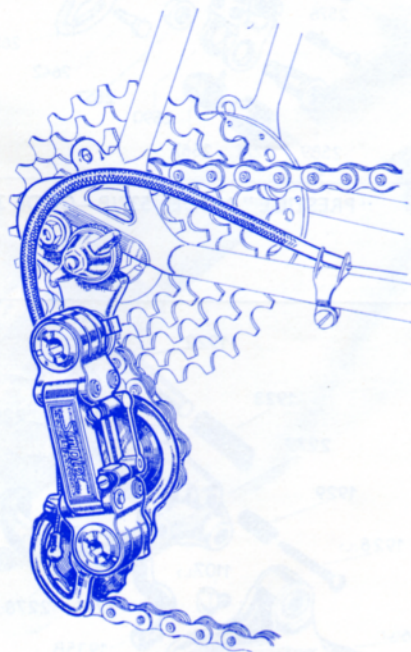

LEVER UNIT LEFT HAND. Ref. 2531.A, with cable and outer casing, as supplied with Code 25.



LEVER UNIT RIGHT HAND. Ref. 2530.A, with cable and outer casing, as supplied with Code 30/P, 32/NC, 33.

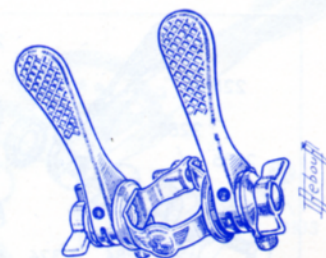

DOUBLE LEVER UNIT. Ref. 2532.A, with two cables and two outer casing, as supplied with Code 25/1, 34, 35, 37.

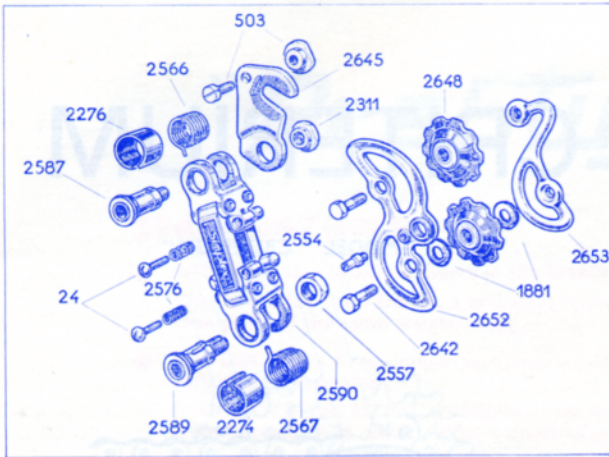

"PRESTIGE" MODEL 537/P—CODE 30/P

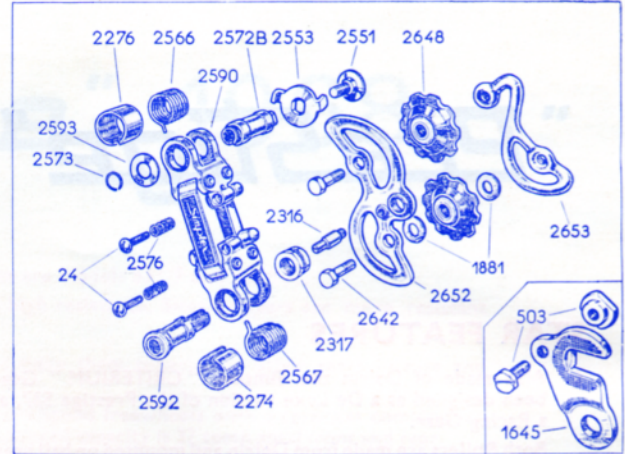

"PRESTIGE" MODEL 537/NC (= 537/NI) (CODE 32/NC)

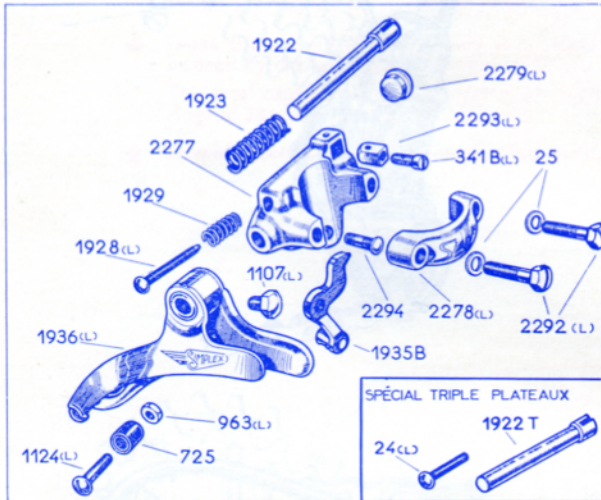

"PRESTIGE" FRONT CHANGER AV.223. (CODE 25)

NOTE—By replacing screw 1928 with screw Ref. 24 and Part 1922 with 1922.T, the changer will operate with triple rings

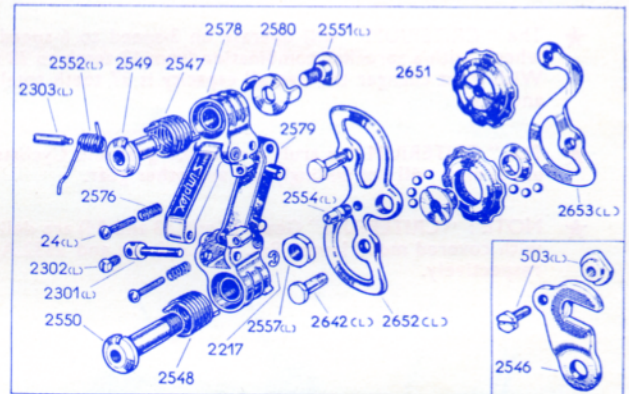

"PRESTIGE" GEAR, MODEL "CRITERIUM" (CODE 33)

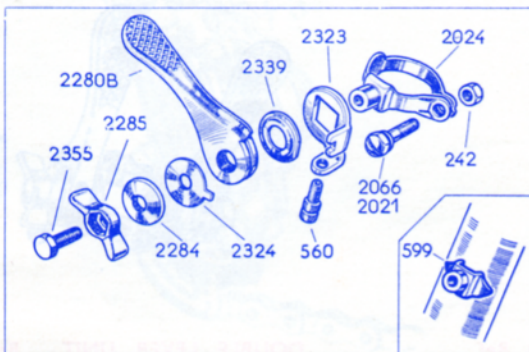

PARTS OF RIGHT HAND LEVER UNIT Ref. 2530
Part 2284 can be ordered in Bright Metal as 2284/CR.

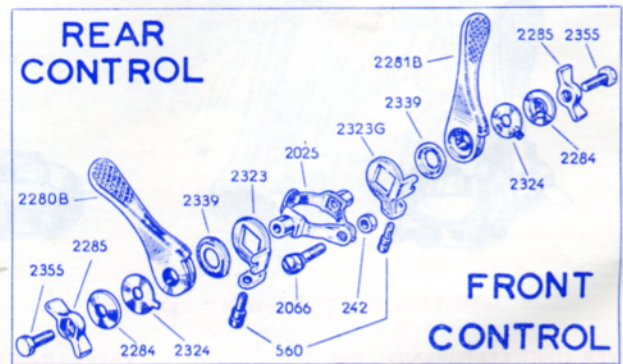

PARTS OF DOUBLE LEVER UNIT Ref. 2532.A.

PRESELECTOR LEVER UNIT "CLICK SHIFT"

The Simplex Preselector lever unit "CLICK SHIFT" is a device that permits the user to select the gear ratio required by shifting the lever into the speed position desired (by number), and the Preselector does the gear changing automatically.

This unit takes out the guessing and the "feel" when gear changing. If you want to run on 3rd speed, operate "CLICK SHIFT" to CLICK INTO No. 3 on Dial, and automatically the Deraillieur Gear will change to 3rd gear. This is a valuable and exciting technical achievement which will be particularly attractive to all non-racing cyclists.

The "CLICK SHIFT" fits on the top tube of the cycle, thus being very handy to operate.

A complete gearing system will consist of one "CLICK SHIFT" (Code 44) which includes cable and outer casing, and one rear gear Mechanism Model 537/P (Code 38), or 537/NC (Code 40). The "CLICK SHIFT" is made to operate on a 5-speed Freewheel and the Dial carries the numbers 1 to 5 (speeds). "CLICK SHIFT" is so easy to use that a child can operate it . . . and will want to because it is such fun.

"CLICK SHIFT" is safe and thus a simili-racing cycle for a 10-year-old child fitted with the Prestige gear is now an exciting possibility.

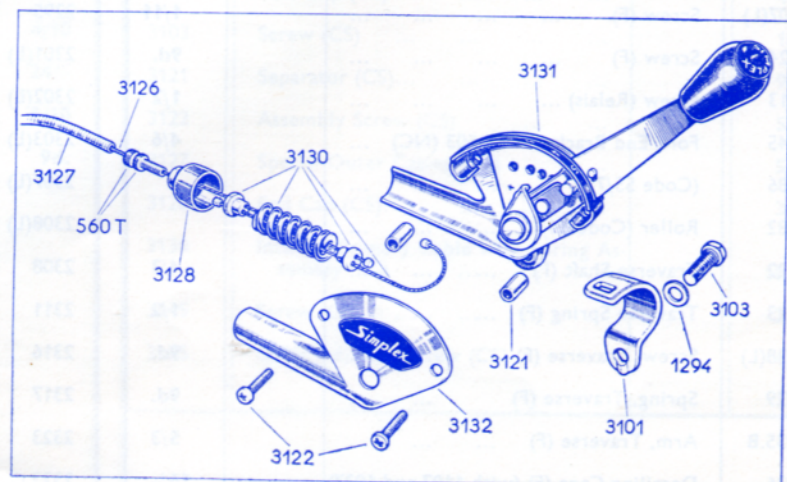
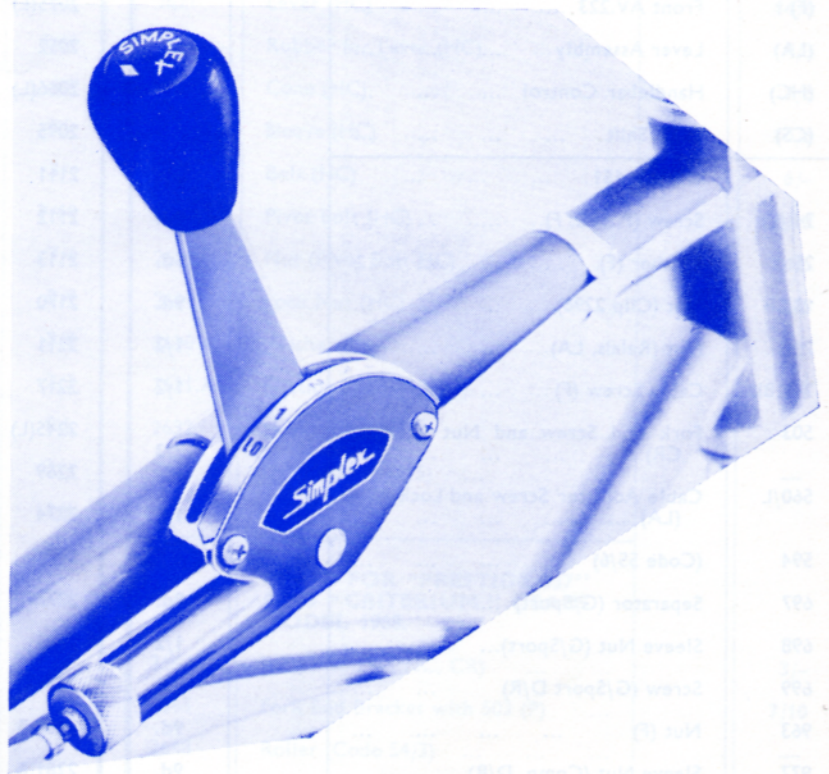

(CODE 151) SIMPLEX PARTS FOR "PRESTIGE" GEARS FROM 1st JANUARY 1968

Part Ref.	ITEM	Retail Price	Part Ref.	ITEM	Retail Price
		Each			Each
(P, NC)	Gears 537 Mod. P, NC		2021	Screw (LA)	1/6
(CR)	Gear "Criterium"		2024(L)	Lever Clip R/H with Screw	4/6
(F)	Front AV.223		2025(L)	Double Lever Clip with Screw	7/6
(LA)	Lever Assembly		2052	Roller (Code 54/2)	
(HC)	Handlebar Control		2066(L)	Screw (LA, Relais)	3/-
(CS)	Click Shift		2095	Plastic Cap for Cable End	5d.
	CODE 151		2111	(Code 52/1)	
24 (L)	Screw (P, NC, F)	9d.	2112	(Code 52/2)	
25	Washer (F)	5d.	2113	(Code 52/3)	
134.B	Nut (Clip 2296)	9d.	2170	Screw (Cable), (P, NC)	1/6
242	Nut (Relais, LA)	1/2	2211	Allen Key (NC, CR)	1/2
341.BL	Cable Screw (F)	1/2	2217	Circlip (CR)	9d.
503	Fork End Screw and Nut (P, NC, CR)	2/3	2245(L)	Roller Bolt (P, NC, CR)	2/8
560/L	Cable Adjuster Screw and Lock Nut (LA)	1/11	2269	Perforated Lever Clip with Screw	4/2
594	(Code 55/6)		2274	Dust Cover (P, NC)	9d.
697	Separator (G/Sport)	9d.	2276	Dust Cover (P, NC)	9d.
698	Sleeve Nut (G/Sport)... ..	1/2	2277	Body Half Clip (F)	10/6
699	Screw (G/Sport D/R)	9d.	2278	Half Clip (F)	3/-
963	Nut (F)	9d.	2279	Dust Cover (F)	9d.
977	Sleeve Nut (Comp. D/R)	9d.	2280.B	Lever R/H (LA)	3/4
990	Arm (Code 106)		2281.B	Lever L/H (LA)	3/4
991.B	Screw (Comp. D/R)	9d.	2284	Domed Washer (LA)	9d.
993	Screw (G/Sport.D/R)	9d.	2285	Lever Wing Nut (LA)	9d.
994	Sleeve Nut (For 993)	9d.	2292	Clip Fixing Screw (F)	9d.
998	Arm (Code 107)		2293	Cable Socket (F)	1/6
1107(L)	Screw (F)	1/11	2294	Rivet (F)	5d.
1124	Screw (F)	9d.	2295	Fork End Bracket with 503 (P)	5/-
1213	Screw (Relais)	1/2	2301(L)	Cable Socket (CR)	3/4
1645	Fork End Bracket with 503 (NC)	4/6	2302(L)	Cable Screw (CR)	1/2
1786	(Code 55/7)		2303(L)	Axle, (For Spring CR)	9d.
1882	Roller (Code 54/1)		2307(L)	Cage Plate, Outer (CR)	8/3
1922	Traverse Shaft (F)	4/3	2308(L)	Cage Plate, Inner (CR)	9/-
1923	Traverse Spring (F)	1/2	2308	Cage Plate, Inner (P, NC)	5/6
1928(L)	Screw, Traverse (F)	9d.	2311	Nut, (Top Pivot, P)	1/10
1929	Spring, Traverse (F)	9d.	2316	Cage Stop (Inner Plate NC)	9d.
1935.B	Arm, Traverse (F)	5/3	2317	Assembling Nut (NC)	1/10
1936	Derailing Cage (F) (with 1107 and 1937)	16/-	2323	Sector Plate (R/H Lever)	3/-
1937	Cage Separator (F) (Assembly 725/963/1124)	3/-	2323.G	Sector Plate (L/H Lever)	3/-
			2324	Dogged Washer (L)	9d.

(CODE 151) SIMPLEX PARTS FOR "PRESTIGE" GEARS FROM 1st JANUARY 1968

Part Ref.	ITEM	Retail Price	Part Ref.	ITEM	Retail Price
		Each			Each
2334	(Code 55/1)			PARTS FOR HANDLEBAR CONTROL	
2338	(Code 55/2)		2620.A	Main Body (HC)	23/-
2339	Washer (L)	1/2	2621	Lever (HC)	14/6
2355(L)	Screw (L)	1/10	2622	Rubber for Lever (HC)	4/3
2546	Fork End Bracket (CR) (with 503) ...	6/9	2624	Cone (HC)	7/6
2547	Top Spring (CR)	3/-	2625	Sleeve (HC)	14/6
2548	Bottom Spring (CR)	3/-	2626	Bolt (HC)	6/-
2549	Top Pivot Axle (CR)	7/10	2627.A	Pivot Bolt (HC)	7/10
2550	Bottom Pivot Axle (CR)	7/6	2628	Nut (Pivot Bolt-HC)	4/6
2551	Nut (NC-CR) (Top Pivot Axle) ...	3/9	2629	Lock Nut (HC)	2/8
2552(L)	Spring (CR) (Parall. Articulation) ...	2/8	2630.A	Washer (HC)	9d.
2553	Washer (NC) (Fork End Locating)	2/3	2631.A	Friction Washer (HC)	2/3
2554	Cage Stop (P, CR) (To Inner Plate)	9d.	2632	Cable (Code 55/4)	—
2556.M	Cage Plate, Outer (P, NC)	3/-	2633	Cable (Code 55/5)	—
2557	Assembling Lock Nut (P, CR) ...	1/6		PARTS FOR "PRESTIGE 537" AND "CRITERIUM" GEARS MODEL 1968.	
2565	Washer (P, NC) (Cable Fixing) ...	9d.	2642(L)	Roller Bolt (P, NC, CR)	3/-
2566	Spring (Top Pivot, P, NC)	1/10	2645	Fork End Bracket with 503 (P) ...	7/10
2567	Spring (Bottom Pivot, P, NC) ...	1/10	2648	Roller (Code 54/3)	—
2572.B	Top Pivot Axle (NC)	7/2	2651	Roller (Code 54/4)	—
2573	Circlip (Top Pivot NC)	5d.	2652	Cage Plate Outer, (P, NC, CR) ...	8/3
2576	Spring (P, NC, CR) (Traverse Movement)	5d.	2653	Cage Plate Inner (P, NC, CR) ...	4/3
2578	Half Parallelogram Arm with Name Plate (CR)	17/3		PARTS FOR "CLICK SHIFT"	
2579	Half Parallelogram Arm (Inner Section) (CR)	14/6	3101	Half Clip (CS)	4/3
2580	Washer (CR) (Fork End Locating) ...	3/6	3103	Screw (CS)	1/6
2587	Top Pivot Axle (P)	4/10	3121	Separator (CS)... ..	9d.
2589	Bottom Pivot Axle (P)	4/10	3122	Assembly Screw (CS)	5d.
2590.M	Parallelogram Unit complete (P, NC)	24/-	3127	Special Outer Casing (CS)	5/3
2592	Bottom Pivot Axle (NC)	5/10	3128	End Cap (CS)	3/9
2593	Washer (NC) (Top Pivot)	9d.	3130	Internal Primary Cable with Spring Assembly (CS)	10/6
			3145	Screw (CS)	2/3
			3155	Cable Adjuster Screw (CS)	4/3

PRICES 1968—For Items Listed in Catalogue No. 50

Code No.			Retail	Code No.			Retail	Code No.			Retail
STRONGLIGHT							Each				Each
170	Pair		59/9	221			9d.	279	Set		19/-
170/L			19/-	223			2/3	280			7/9
170/R			43/-	224			4/-	281			8/6
171/L			19/-	225			6/3	282			4/9
171/R			43/-	226			7/3	283			39/-
173	Pair		49/9	227			6/3	284			39/-
173/L			19/-	230			34/9	262			4/6
173/R			32/6	231			21/9	287			53/-
174-5	46, 47, 48		17/-	234/1			3/9	289			53/-
	, 49, 50		19/-	234/2			2/9	290			53/-
	52		22/-	234/3			5/9	295			69/-
190	Set		189/9	234/4			4/9	296			69/-
195	Set		250/-	234/5			5/9	298			69/-
196	48, 49, 50		49/-	234/6			5/6	300			63/-
	51, 52		55/-	234/7			2/9	MAGISTRONI			
	53, 54		67/-	234/8			15/6	335	Pair		39/9
	55, 56		69/9	234/9			10/-	335/R			27/6
201	Set		—	236			29/-	335/L			13/9
204	40, 42, 44, 45		43/-	237			29/-	337-8	47, 48, 49		9/-
	46, 47, 48		45/-	240			65/9		50, 51, 52		13/9
	49, 50, 51, 52		51/9	241			65/9	343	Sachet of 6		1/3
	53, 54		59/6	242			65/9	366	Sachet of 6		1/-
	55, 56		67/-	243			67/9	370			19/9
204/1			2/3	244			67/9	NERVEX			
211	44 to 48		41/9	250	To 252		120/-	404	407-414		17/3
212	49 to 52		57/-	254	To 257		148/-	425-	430		26/6
215	With Screws		139/-	260			6/6	434			4/6
216	With Screws		139/-	261			7/-	436			8/-
217			69/9	262			4/6	437			4/6
218			49/9	263	Set		16/-	451	(Pair)		2/-
219			3/-	264			16/9	453-4	(Pair)		2/-
220			15/9	265			16/9	457	(Pair)		2/6
220/A			8/9	270			54/9	461-3	(Pair)		4/-
220/B			8/-	271			54/9	480/2	Min. 100 (Per 100)		—
220/C			1/9	272			54/9	480/6	Min. 100 (Per 100)		—
220/1			3/-	274			57/-	480/10	Min. 100 (Per 100)		—
				275			57/-				
				278			3/6				

PRICES 1968—For Items Listed in Catalogue No. 50

Code No.		Retail
	PIVO	Each
500		21/-
510/9		17/-
510/11		18/3
512/9		18/-
512/11		19/3
520		2/6
522		1/9
	AMBROSIO	
600-	601	33/-
605		33/-
612	8, 9, 10	42/-
	11, 12	44/6
	13	47/-
614	8, 9, 10	37/6
	11, 12	39/9
	13	42/6
615		7/-
616		2/9
618		1/9
	AVA-EVIAN	Each
	"COMPETITION" RACING RIMS FOR TUBULARS.	
635	32.H	39/9
636	40.H	39/9
637	36.H	39/9
638	28.H	39/9
SPECIAL NETT PRICE FOR CARTON OF 20 UNITS AVAILABLE		
	NISI-EVIAN DURAL RIMS	Each
646-	647-648	21/6
650-	651-652	28/-
653-	654-655	33/-
657-	658	45/-
659	(Sachet 40)	7/3
SPECIAL NET PRICE FOR CARTON OF 20 UNITS AVAILABLE		

Code No.		Retail
	"FB-HUBS"	Each
675-6		36/9
677-8		39/-
680-1		47/3
682-3		45/-
684-5	686-7	47/9
700-2		46/3
705-7		47/6
710-2		57/6
713-4		55/3
715-6	717-9	57/6
725		4/6
726	FB/1	4/6
	FB/2	4/9
	FB/3	6/9
	FB/4	7/-
	FB/5	10/9
	FB/6	11/9
727	FB/7	6/-
	FB/8	6/9
	FB/9	6/9
	FB/10	7/-
	FB/11	10/9
	FB/12	11/9
	"E" Spokes / Nipples	Gross
730	To 730/4	24/9
731	To 731/4	22/6
733	To 733/4	19/6
734	To 734/4	17/6
	Min. 5 Gross Per Size	
737	Min. 5 Gross	8/-
738	Min. 5 Gross	8/-
	Plus Carriage	

Code No.		Retail
	EXCELTO	Each
740/BG		6/3
741		10/9
742/BG		6/3
743		10/9
746		11/-
747		8/-
770/BG		9/3
791/BG		11/9
792/BG		11/9
793/BG		12/6
794/BG		12/6
796		13/9
797		13/9
798		14/3
799		14/3
810		12/9
811		14/3
815		18/9
816		21/-
817		21/-
818		22/3
819		22/3
820		14/9
821		18/6
824		23/9
825		26/9
830		4/9
831		6/-
832-	833	2/3
835		1/9
836-	837	2/3
839-	841	1/9
O.E. TERMS AVAILABLE		
Refer	PIRELLI to New Code No. 1600 up	
944	AURELIA	5/9

PRICES 1968—For Items Listed in Catalogue No. 50

Code No.			Retail	Code No.			Retail	Code No.			Retail
952	MAFAC Set		Each 75/-	Part Ref. 54/DE		Each 5/3	Part Ref.	For CYCLO- MOTEUR™		Each
954	Set		69/9	54/GE		5/3	554DEC	Stirrurp, R/H		7/6
955-	956, Each		29/6	56.E		3/6	554GEC	Stirrurp, L/H		7/6
957-	958, Each		29/6	56/A		5d.	556EC	Clamp Bolt Assembly ...		3/9
959	Set		59/9	56/B		9d.	560EC	Drawbolt Assembly ...		2/3
959/1	Set		59/9	57		2/-	565	Front Guide for O/Casing, Tandem 28 m/m ...		4/6
959/2	Set		56/6	58		2/-	569	(Code 969/6)		—
960	Set		66/9	59		1/3	663E/664	Brake Shoe with Block (Tandem)		6/6
961/L			12/6	60.E		2/-	664	Brake Block (5 Stud) ...		1/6
961/R			12/9	60/CEC		2/9	665/28C	Front Cable Hanger, Tandem 28 m/m ...		3/9
962			16/9	60/A		9d.	851.A		11/3
963			12/-	60/CC		2/-	852.AR		11/3
963/D			16/-	61.EC		4/6	854.D		15/-
964/L	, 964/R Each		9/9	62		5d.	854.G		15/-
965	Min. 10		1/2	63.E/64	(Code 971)		3/6	857		2/-
966	Min. 10		1/10	64	(Code 970)		10d.	858		2/-
966/1	Min. 10		3/-	65		3/6	869	(Code 969/3)		—
967	Min. 10		1/10	66		1/6	863/B		9d.
968	Min. 10		3/9	67		2/-	863.E/64		6/6
968/1	Min. 10		2/9	68		9d.	1054.D		6/9
969/1	Min. 10		1/10	69	(Code 969/1)		—	1054.G		6/9
969/2	Min. 10		1/10	75/78	To 80		7/3	1057		2/-
969/3	Min. 10		3/4	77	To 80		5/3	1058		2/-
969/4	Min. 10		1/10	81	Braze-on Cable Stop.		9d.	1069	(Code 969/4)		—
969/5	Min. 10		2/8	452.E		9/9	1151.ME		7/6
969/6	Min. 10		1/10	454.D		11/-	1151.FE		8/6
970	(Card 48)			454.G		11/-	1154.D		12/6
971	(Card 24)			456.E		4/6	1154.G		12/6
975			10/3	456.A		9d.	1157		2/-
977			16/-	456.B		9d.	1158		2/-
978			22/-	457		2/-	1169	(Code 969/5)		—
980			16/-	458		2/-	103		9d.
981			22/-	460.E		2/6	106.E		5/3
982			25/-	460.B		5d.	108		9d.
983			58/-	469	(969/2)		—	112		2/9
987			2/4	491.E		5/3	RMT/-	White, Red, Blue, Green		5/3
51.E	Part Ref.		3/6	493.E		5/9	RM/DC	Rubber Hood. White (Twin Cable Prof. Lever ...		6/9
52.E		3/6	495		2/-	F	White Sheath for Prof. Lever		2/6
53/A		5d.	496		1/6				
53/C		2/-	499		3/-				

"AVA-EVIAN"

The New Pro. racing rim

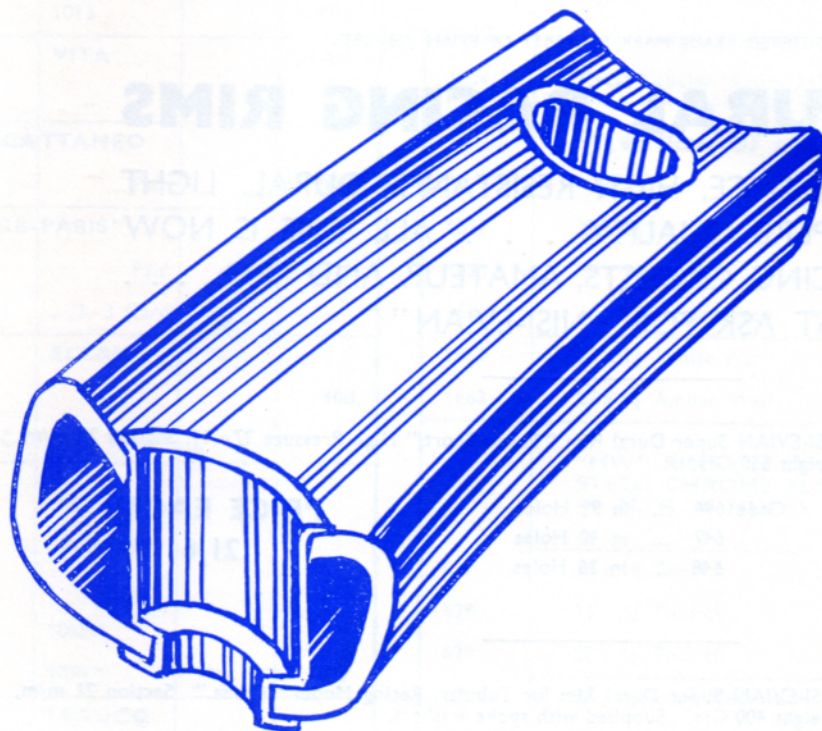

39/9

EACH

Available in
28, 32, 36, 40 Holes
SUPER DURAL

This NEW AVA-EVIAN rim has been developed specially for professional Road Racing. It is made from Top Grade, high resistance Dural, formed with precision and beautifully finished. THE MOST IMPORTANT FEATURES ARE IN THE EYELET CUPS.

- ★ Eyelet Cups riveted on base of rim for greater rigidity . . . AN EXCLUSIVE FEATURE
- ★ Top of eyelet cups seat flush at top of rim to give smooth surface for seating Tubular . . . AN EXCLUSIVE FEATURE
- ★ Eyelet Cups are ANGLED to follow the direction of the spoke, ensuring straight spokes and greater rigidity of wheel . . . THIS IS A PATENTED EXCLUSIVE FEATURE

THIS RIM IS AVAILABLE NOW!

Code No.	DESIGNATION	Retail Price
(665)	"Ava-Evian" Dural Rims "Competition," 32.H	Each 39/9
(666)	"Ava-Evian" Dural Rims "Competition," 40.H	Each 39/9
(667)	"Ava-Evian" Dural Rims "Competition," 36.H	Each 39/9
(668)	"Ava-Evian" Dural Rims "Competition," 28.H	Each 39/9

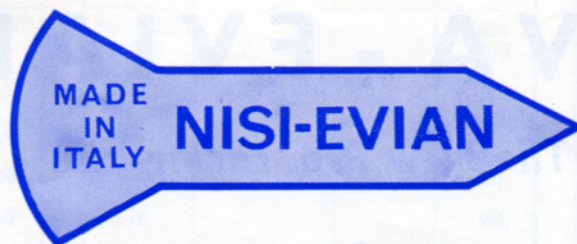

BRITISH REGISTERED TRADE MARK PROPERTY OF EVIAN (GB) LTD.

SUPER DURAL RACING RIMS

A DE LUXE APPEARANCE, HIGH RESISTANCE DURAL, LIGHT IN WEIGHT, A SUPERB QUALITY . . . ALL THIS IS NOW AVAILABLE TO RACING CYCLISTS, AMATEUR AND PRO. . . . JUST ASK FOR "NISI-EVIAN"

LIGHT ALLOY
SUPER-SPORT
27 X 1¼

NISI-EVIAN Super Dural Rim "Super Sport," High Pressure 27 × 1¼, Section 23 m/m, Weight 550 Grs.

Code 646 ... in 32 Holes
647 ... in 40 Holes
648 ... in 36 Holes

PRICE EACH
21/6

LIGHT ALLOY
CORSA

NISI-EVIAN Super Dural Rim for Tubular, Racing Model "Corsa." Section 21 m/m, Weight 400 Grs. Supplied with spoke washers.

Code 650 ... in 32 Holes
651 ... in 40 Holes
652 ... in 36 Holes

PRICE EACH
28/-

LIGHT ALLOY
SUPER CORSA

NISI-EVIAN Super Dural Rim for Tubular, Road and Track Racing, Model "Super Corsa." Section 21 m/m, Weight 330 Grs. Supplied with special Metal-Fibre spoke washers.

Code 653 ... in 32 Holes
654 ... in 40 Holes
655 ... in 36 Holes

PRICE EACH
33/-

LIGHT ALLOY
PISTA

NISI-EVIAN Super Dural Rim for Tubular, Track Racing, Model "Pista." Extra Narrow Section 19 m/m, Weight 220 Grs. Supplied with special Metal-Fibre spoke washers.

Code 657 ... in 36 Holes
658 ... in 28 Holes

PRICE EACH
45/-

659 ... Sachet, Nisi-Evian Metal-Fibre Rim Washers (Sachet of 40) 7/3

PRICES 1968—For Items Listed in Catalogue No. 50

Code No.		Retail
		Each
Prices	as at List 1st Feb., 1966	
	NERVAR	
1010-	AD-HOC 1013	17/9
1021	VITA	6/9
1022	,,	7/6
	NOLICATTANEO	
1025	Pair	29/9
	"GB-PARIS"	
1033	Pair	2/9
1033/1	,-/2,-3 Card	—
	ECLAIR	
1035		10d.
1035/C	Card	
	"EVIAN" SUN GLASSES	
1037		8/9
1038-	1038/1	7/9
1039-	1039/1	7/9
	LEDUCQ	
1040	Pair	6/9
1042		1/6
	DETTO PIETRO	Pair Incl. P. Tax
1045	G. Sport	89/9
1047	Criterion	130/-
1048	Prof.	123/9
1049	Hinverno	99/9
1051	Stelvio	149/9
1053		3/9
	HELYETT	Each
1575		49/6
1580		5/9
1581		1/10

Code No.	ITEM	Retail
	PIRELLI EXTRACT FROM MAIN PIRELLI CATALOGUE FOR ALL SIZES TYRES AND TUBES FOR ALL TWO WHEEL MACHINES.	Each
1600	Cycle Tubular "Gran Premio" ...	33/9
1601	Cycle Tubular "Leggero" ...	75/-
1602	Cycle Tubular "Leggerissimo" ...	75/-
1604	Cycle Tubular "Corsa 300" ...	49/9
	SELECTION OF CYCLE TYRES	
1631	26 x 1 3/8 ...	13/6
1633	26 x 1 3/8 W/Wall ...	16/-
1634	26 x 1 3/8 Amber/Wall ...	18/3
1662	27 x 1 1/4 White Wall ...	16/9
1663	27 x 1 1/4 Amber Wall ...	18/3
	"MW" RIMS (DE-LUXE) STEEL, CHROME PLATED IN 32, 36, 40 HOLES	Each
627	26 x 1 3/8, Endrick ...	15/3
628	26 x 1 1/4, Endrick ...	15/3
629	27 x 1 1/4, Endrick ...	15/3
630	26 x 1 1/4, High Pressure ...	16/9
631	27 x 1 1/4, High Pressure ...	16/9
633	27 x 1 1/4, High Pressure ... Depressed Holes	18/-
639	26 x 1 3/8, Westwood ...	15/3
640	28 x 1 1/2, Westwood ...	—